

134	543255.975	438343.540	941.155	CCLP
151	543276.401	438367.403	940.724	POA
221	543310.285	438461.557	942.401	LP
295	543329.555	438570.635	943.439	LP
428	543249.557	438552.808	941.291	CF
465	543235.955	438556.022	940.380	MD
515	543221.976	438504.823	940.840	LP
547	543215.724	438490.882	940.417	COTA
605	543190.099	438512.626	939.854	LP
648	543156.731	438520.853	940.544	POA
690	543140.146	438496.679	940.249	LP
726	543114.395	438444.915	939.653	PLATF
820	543073.212	438441.445	939.273	LP
848	543087.351	438410.468	938.857	LP
969	543162.940	438368.209	939.850	LP
984	543173.493	438362.393	939.758	CAMIN
994	543193.798	438380.039	940.311	COTA
1027	543165.701	438366.633	939.751	LP
1030	543204.910	438362.142	939.778	CAMIN
1122	543252.016	438366.014	940.753	LAMP
1196	543299.255	438437.430	942.024	POA
1200	543301.905	438442.099	942.069	LP
1224	543293.563	438466.410	942.174	GBINT
1313	543220.551	438337.806	939.115	COTA
1314	543210.294	438341.815	939.626	COTA

PLAN DE SITUATIE
FABRICA DE STICLA AZUGA
SCARA 1:500

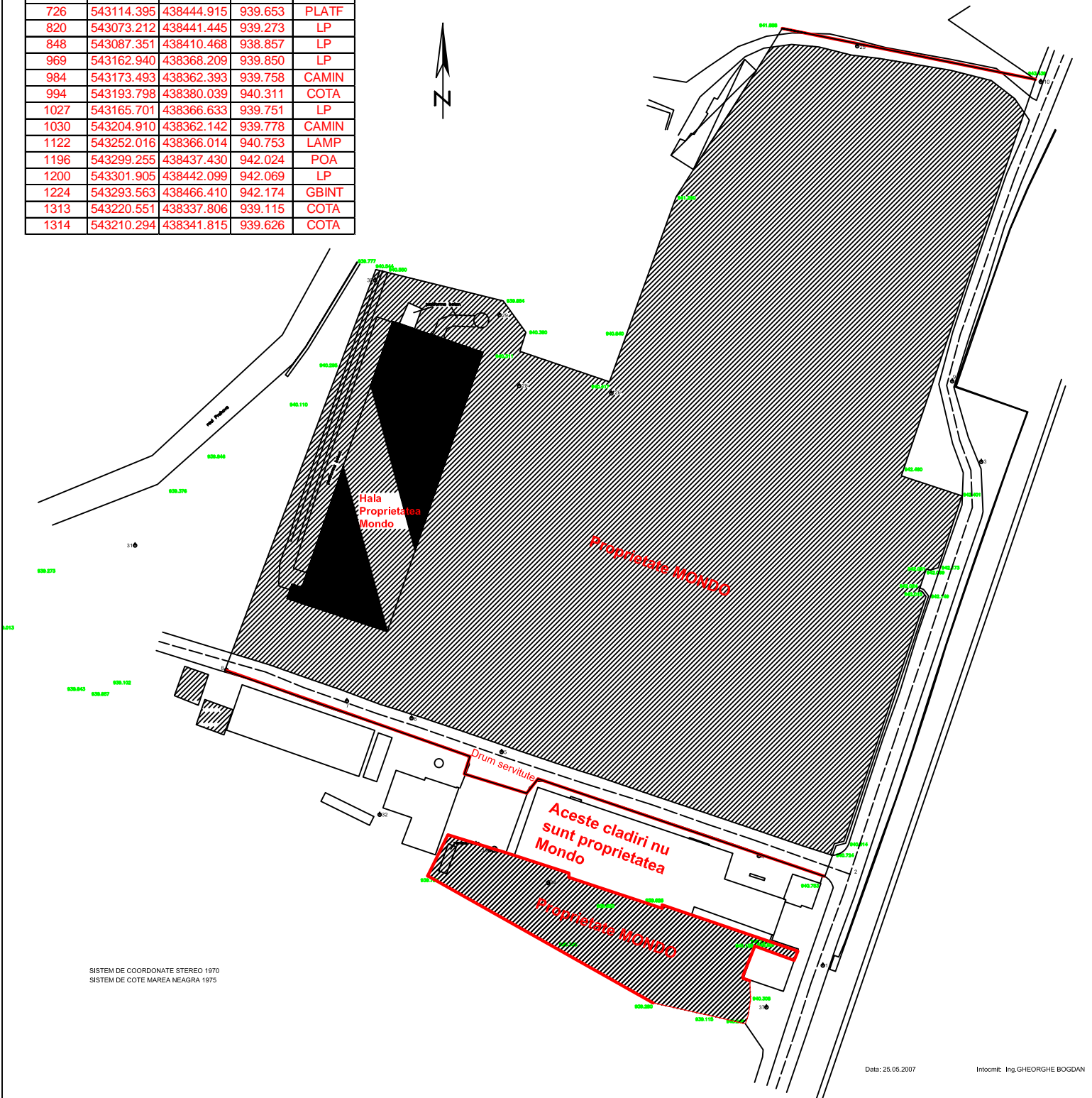

SISTEM DE COORDONATE STEREO 1970
SISTEM DE COTE MAREA NEAGRA 1975

Data: 25.05.2007

Intocmit: Ing.GHEORGHE BOGDAN